



PUSH/PULL SWITCHES

Model Series 6204

- 5A current rating at 9-16 VDC
- Use in battery-powered applications up to 96 VDC
- Self cleaning contacts increase switch life by preventing carbon buildup
- Snap-in mounting type
- Rugged and ergonomic
- RoHS, REACH and Conflict Mineral compliant

OPERATION

Delta Systems' push/pull switches control switching for up to 3 independent circuits. Typical applications include implement control for outdoor power equipment and industrial equipment. Knob can be customized for color and graphics.

ELECTRICAL SPECIFICATIONS

Cycle Life:	Resistive: 100,000, Inductive: 40,000
Operating Voltage Range:	9-96 VDC
Operating Current:	250mA–5A @ 9-16 VDC, 250mA-500mA @ 48-96 VDC
Contact Resistance:	50 mΩ @ 5A, 12 VDC

ENVIRONMENTAL RATINGS

Exposure	Specification
Ingress Protection	IEC 60529, IP53
Operating Temperature Range	-30 °F to 150 °F
Chemical Resistance	Gasoline, Diesel Fuel, Hydraulic Oil, Engine Oil, Bug repellent DEET, Salt Water, Wax, Sunscreen, Insect Killer, Weed Killer, Liquid Fertilizer, Bleach disinfectant spray, Fungicide, Mole repellent, Bleach, Ammonia, Degreaser, Battery Acid

AVAILABLE CONFIGURATIONS

Part number	Electrical Config	Knob Style	Knob Color	Graphics	Graphic Color
6204-204	NO\ \DT	1.5" Diameter	Red	A	White
6204-206	NC\ \DT	1.5" Diameter	Red	B	White
6204-207	\DT\DT	1.5" Diameter	Yellow	None	-
6204-208	\DT\DT	1.5" Diameter	Black	None	-
6204-209	NC\ \DT	1.5" Diameter	Red	A	White
6204-210	\DT\DT	1.5" Diameter	Yellow	B	Black
6204-211	\DT\DT	1.5" Diameter	Black	B	Silver
6204-212	NC\ \DT	1.5" Diameter	Yellow	A	Black
6204-219	NC\ \DT	1.5" Diameter	Yellow	B	Black
6204-220	\DT\DT	1.25" Diameter	Red	None	-
6204-303	NO\DT\DT	1.5" Diameter	Black	A	White
6204-308	NC\NO\DT	1.5" Diameter	Black	A	White
6204-313	NO\DT\NC	1.5" Diameter	Black	A	Silver
6204-315	NO\DT\DT	1.5" Diameter	Yellow	A	Black
6204-316	NO\DT\DT	1.5" Diameter	Red	A	White
6204-318	NO\DT\DT	1.5" Diameter	Red	B	White
6204-320	NO\DT\DT	1.25" Diameter	Red	None	-
6204-321	NO\DT\DT	1.25" Diameter	Red	C	White
6204-322	NC\DT\DT	1.25" Diameter	Red	C	White
6204-325	NC\DT\DT	1.25" Diameter	Yellow	None	-
6204-331	NO\DT\DT	1.25" Diameter	Black	D	White
6204-341	NO\DT\DT	1.5" Diameter	Yellow	B	Black
6204-342	NC\DT\DT	1.25" Diameter	Yellow	C	Black
6204-348	NO\DT\DT	1.5" Diameter	Black	H	White
6204-353	NC\DT\DT	1.25" Diameter	Red	None	-
6204-358	NC\DT\DT	1.5" Diameter	Yellow	B	Black
6204-362	NC\DT\DT	1.5" Diameter	Yellow	A	Black

PUSH/PULL SWITCHES

Model Series 6204

DIMENSIONS

Note: Please refer to the Application print

1.5" Knob Style

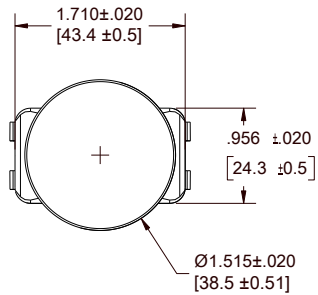

1.25" Knob Style

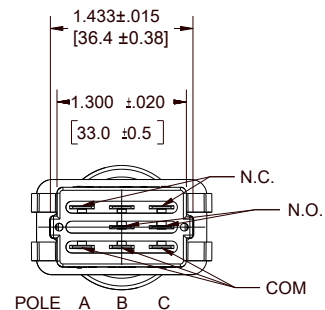
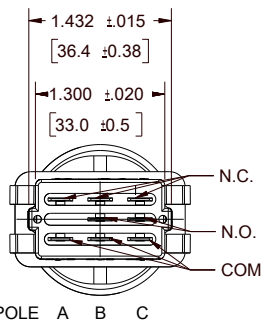
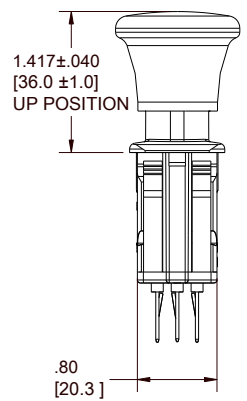
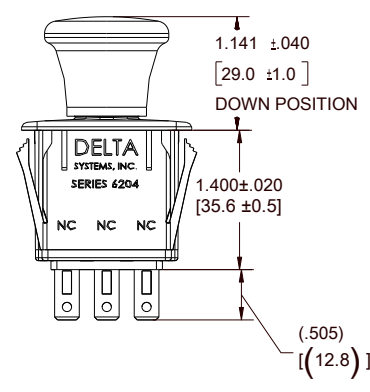
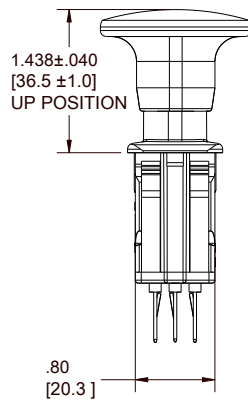
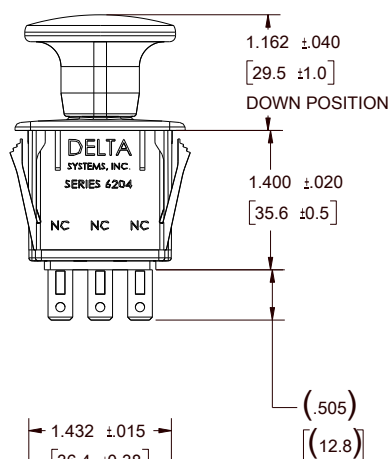
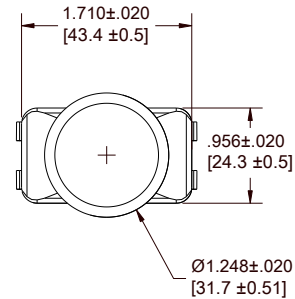

RECOMMENDED MOUNTING

Snap-in mounting with a 1.455" x 0.830" rectangular cut-out

Panel thickness, including paint, overlays, and/or any other layers applied between switch and panel:

.055*, .085*, .105, .135, and .165 (* Requires retainer—see Accessories section)

PUSH/PULL SWITCHES

Model Series 6204

CONNECTION

All models have integral .032 x .250 blade terminals that mate with standard 1/4" female terminals. It is recommended to use a Delta Systems connector housing with the terminals (see Accessories section).

GRAPHIC OPTIONS

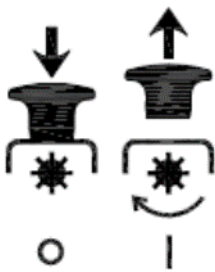

A
EP010, EP057

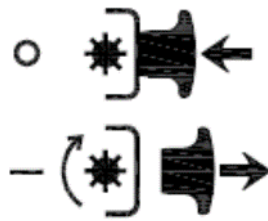

B
EP011, EP061

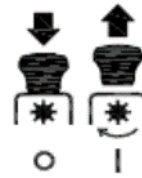

C
EP016

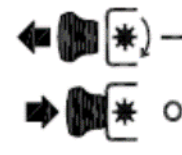

D
EP013



E
EP017

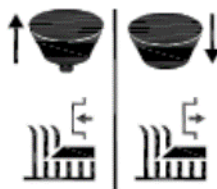

F
EP022



G
EP025

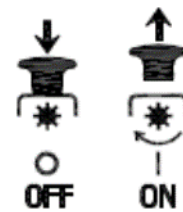

H
EP044

ACCESSORIES

Item #	Manufacturer	Description
972301	Delta Systems	Retainer
972305	Delta Systems	Connector Housing (NC Pole A)
972306	Delta Systems	Connector Housing (NO Pole A)

Note: Life expectancy and switch performance are largely dependent on application. It is the user's responsibility to determine suitability of this product for the application. This information is intended as a guide for proper application.