

REVISIONS			
~	INITIAL RELEASE, CR 929	2/27/97	TW
A	ADDED NAME TO HOUSING, CR 1017	08/19/97	TW
B	REMOVED COLOR IDENTIFIER, CR 1719	04/30/08	MA
C	UPDATE MATERIAL, CR1908	07/21/10	ERB

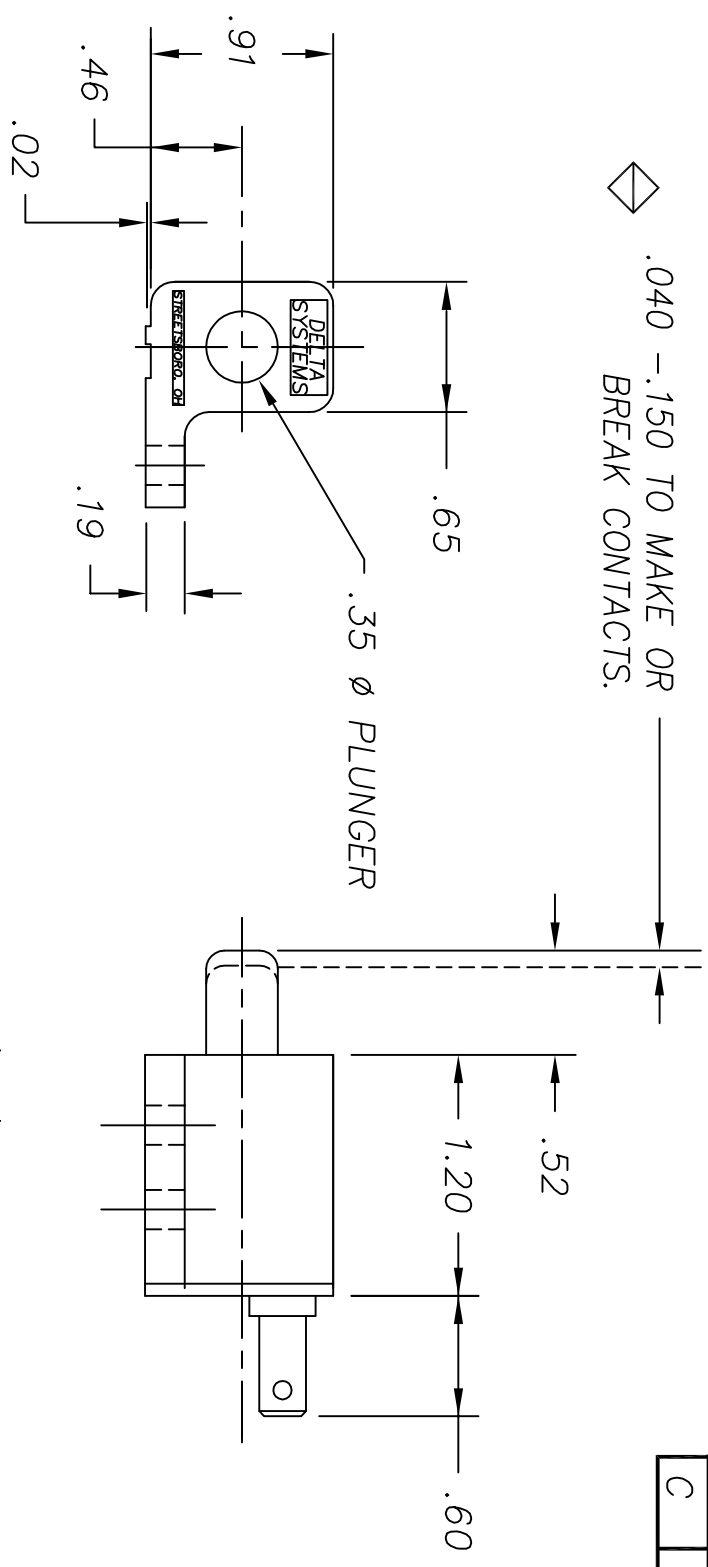

NOTES:

- 1 - TERMINALS ARE NICKEL PLATED.
- 2 - PLASTIC PARTS ARE POLYPROPYLENE.
- 3 - HOUSING AND PLUNGER ARE GRAY.  
BACK COVER IS OLIVE.
- 4 - DATE CODE INDICATING YEAR, MONTH, AND DAY OF MONTH MANUFACTURED STAMPED ON HOUSING.
- 5 - INTEGRITY OF WELD & SWITCH FUNCTIONALITY TESTED AFTER ASSEMBLY.
- 6 - THIS PRODUCT COVERED BY THE FOLLOWING U.S. PATENT; 4,812,604. OTHER PATENTS APPLIED FOR.

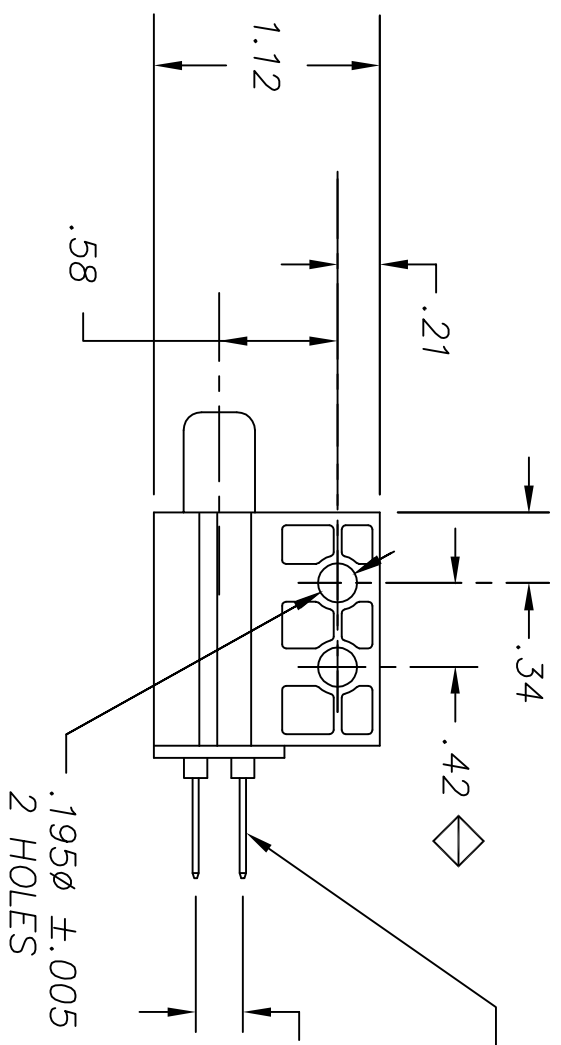

<p>DELTA SYSTEMS, INC. DOES NOT ASSUME ANY LIABILITY ARISING OUT OF THE MISAPPLICATION OF ANY PRODUCT</p>		<p>UNLESS OTHERWISE SPECIFIED DIMENSIONS ARE IN INCHES TOLERANCES ARE: .xxx± .02 .xxx± .005 ANG± 1°</p>	
<p>COMPUTER GENERATED DRAWING - NO MANUAL CHANGES ALLOWED</p>		<p>DO NOT SCALE DRAWING</p>	
<p>DRAWN LMM</p>	<p>DATE 02/26/97</p>	<p>DELTA SYSTEMS INC. STREETSBORO, OHIO 44241</p>	
<p>CHECKED TW</p>	<p>DATE 2/27/97</p>	<p>N.O. PLUNGER SWITCH S.P.S.T. W/2LB. SPRING</p>	
<p>MATERIAL AS NOTED</p>		<p>FINISH AS NOTED</p>	<p>SCALE FULL</p>
<p>SIZE B</p>		<p>DWG. NO. 6400-88</p>	<p>PROJECT NO. EX311</p>
<p>REV C</p>		<p>REV C</p>	