

REVISIONS			
REV.	DESCRIPTION	DATE	INIT
0	INITIAL DRAWING RELEASE	11/16/2016	LJM
1	1.55 WAS 1.51, CHG NOTE 4	12/09/2016	BSW

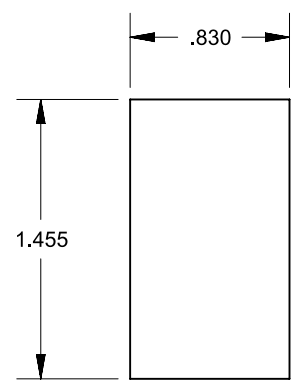

.002 R. MAX ALL EDGES THIS SIDE

DRAFT THIS SIDE IS RECOMMENDED

SWITCH ENTERS FROM THIS SIDE

NO BURRS THIS SIDE

RECOMMENDED MOUNTING HOLE

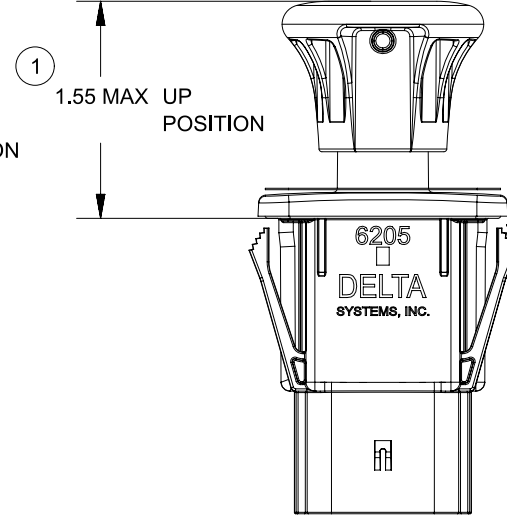
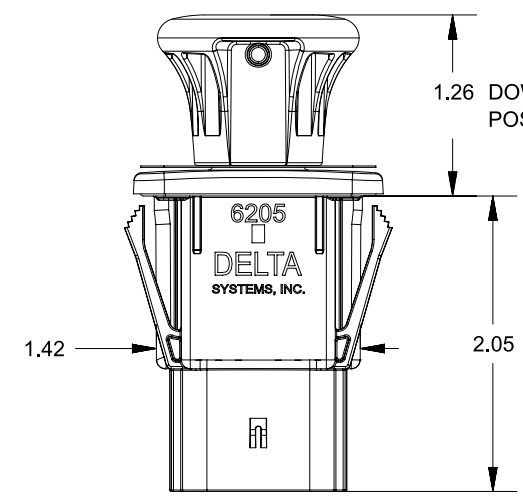
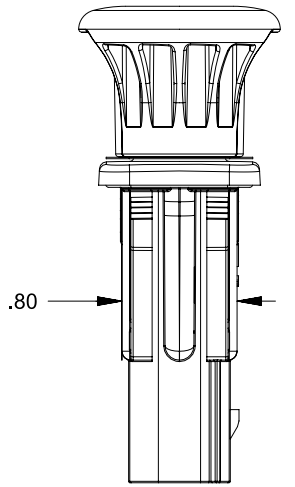
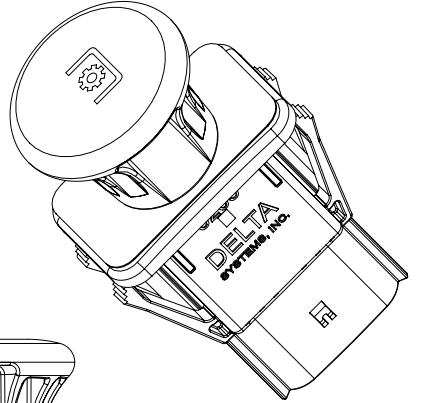
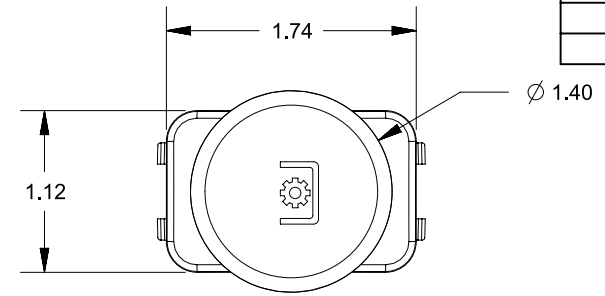

SNAP WINGS DESIGNED TO ACCOMODATE PANEL THICKNESSES OF .060 TO .165 INCLUSIVE OF ANY PAINT, DECALS, ETC.

NORMALLY OPEN (NO) CIRCUITS 1-7, 3-9, 5-11

NORMALLY CLOSED (NC) CIRCUITS 2-8, 4-10, 6-12

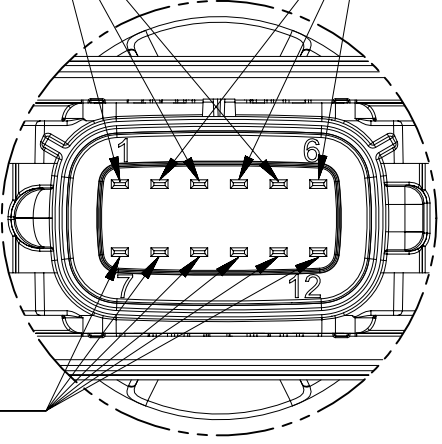

MATING CONNECTOR: MOLEX MX-150 SEALED CONNECTOR P/N 33472-1201 MOLEX FEMALE TERMINALS - 33012 SERIES

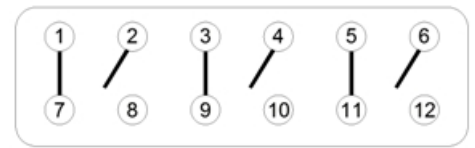

CIRCUITS SHOWN WITH THE KNOB IN THE UP POSITION

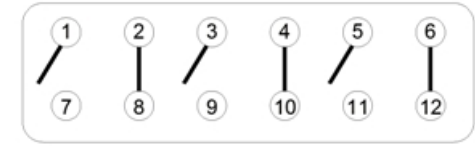

CIRCUITS SHOWN WITH THE KNOB IN THE DOWN POSITION

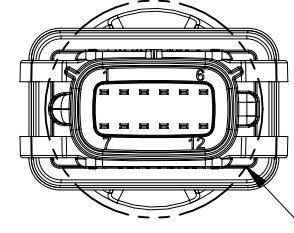

DETAIL B

NOTES

- 1) MATERIALS:
BODY - POLYPROPYLENE, BLACK
KNOB - POLYPROPYLENE, YELLOW
TERMINALS - BRASS
- 2) KNOB GRAPHIC DESIGN AS SHOWN, PRINTED IN BLACK
- 3) SWITCH MUST WITHSTAND 40 POUNDS OF FORCE WITHOUT PULLING OUT OF PANEL OR DAMAGING SWITCH
- 4) ON (UP) FORCE 13±3 POUNDS ; OFF (DOWN) FORCE 11±3 POUNDS ①
- 5) OPERATING FORCES ARE DETERMINED AFTER 10 CYCLES
- 6) DELTA SYSTEMS INC. RECOMMENDS THE USE OF 14 AWG WIRE FOR CIRCUIT LOADS OF 8-10 AMPS. USE OF LIGHTER GAGE WIRE MAY RESULT IN PREMATURE FAILURE OF THE SWITCH.
- 7) SWITCH IS ENVIRONMENTALLY SEALED TO MEET IP-67 REQUIREMENTS WITH MATING CONNECTOR INSTALLED
- 8) NO (NORMALLY OPEN) AND NC (NORMALLY CLOSED) CIRCUITS ARE RATED TO 100,000 CYCLES WITH A 10mAMP - 10AMP RESISTIVE LOAD, 12-14 VDC.
- 9) NO (NORMALLY OPEN) CIRCUITS ARE RATED TO 40,000 CYCLES WITH A 10AMP INDUCTIVE LOAD, 12-14 VDC, WITH A SUPPRESSION DIODE ACROSS THE COIL.
- 10) DATE CODE INDICATING YEAR, MONTH AND DAY OF MONTH MANUFACTURED MARKED ON HOUSING PER DELTA MFG SPEC 1640
- 11) SWITCH FUNCTIONALITY TESTED AFTER ASSEMBLY
- 12) MOUNTING PANEL IS SHOWN FOR REFERENCE ONLY AND IS NOT INCLUDED
- 13) INTERPRET THIS DRAWING IN ACCORDANCE WITH ASME Y14.5-2009

DETAIL B SCALE 3:2

PROPRIETARY & CONFIDENTIAL THE INFORMATION CONTAINED IN THIS DRAWING IS THE SOLE PROPERTY OF DELTA SYSTEMS. ANY REPRODUCTION IN PART OR AS A WHOLE WITHOUT THE WRITTEN PERMISSION OF DELTA SYSTEMS IS PROHIBITED.

DELTA SYSTEMS INC. DOES NOT ASSUME ANY LIABILITY ARISING OUT OF THE MISAPPLICATION OF ANY PRODUCT

UNLESS OTHERWISE SPECIFIED DIMENSIONS ARE IN INCHES TOLERANCES ARE:
.X± .1
.XX± .02
.XXX± .005
X°± 1°

COMPUTER GENERATED DRAWING - NO MANUAL CHANGES ALLOWED

DRAWN bwetrich	DATE 19-Sep-2016
CHECKED lmonaco	DATE 21-Sep-2016
APPROVED jgallagher	DATE 16-Nov-2016
MATERIAL SEE NOTES	PROJECTED VIEWS ARE 3RD ANGLE
FINISH SEE NOTES	DO NOT SCALE DRAWING
STATUS DS4_Design	

SCALE NTS	SHEET 1 OF 1
PROJECT NO. EX0271	REVISION 1

DELTA SYSTEMS
1734 FROST ROAD
STREETSBORO, OHIO 44241
330-626-2811
WWW.DELTASYSTEMSINC.COM

TITLE
Platform PTO 6205-131C APP PRINT

SIZE
B

DWG. NO.
6205-131C_APP